



ANDERSON UNIVERSITY

ATHLETICS MASTER PLAN

BOUDREAUX



THE LANDPLAN GROUP SOUTH
Landscape Architecture | Engineering | Planning



Table of Contents

ACKNOWLEDGEMENTS	5
EXECUTIVE SUMMARY	6
OBJECTIVES	
NEEDS	
SUMMARY OF RECREATIONAL FACILITIES	
ANALYSIS	7
EXISTING SITE CONDITIONS	8
SITE ANALYSIS	11
EXISTING FACILITIES ANALYSIS	12
SUMMARY OF STAKEHOLDER INPUT	15
GUIDING PRINCIPLES	
WISH LIST FOR ATHLETIC FACILITIES	
IMPROVEMENTS FOR ALL OF ATHLETICS	
RECOMMENDATIONS	16
SUMMARY OF RECOMMENDED FACILITIES & SITE OPTIONS	17
MASTER PLAN	21
RECOMMENDED PHASING AND PRIORITIES	22
DESIGN CONCEPTS	23
RECOMMENDED FACILITIES SPACE PROGRAM	29
ADDITIONAL PLAN OPTION	43

Acknowledgments

The Anderson University Athletics Master Planning Workshop was a team effort. This would not have been possible without the vision of Bill D'Andrea and Mark Vaughan or without the support of University Leadership and the Core Team. This workshop was an investment of time and resources, but one that rallied enthusiasm and great ideas. The BOUDREAUX team would like to thank the Core Team for their leadership and hospitality. Becky Farmer was a fantastic team player, and the staff of the Ross Center truly rolled out the red carpet and created a perfect place for brainstorming and working. Our team enjoyed our time on campus and left hopeful for the vision and the commitment to excellence that was demonstrated.

Athletics Core Team

President Evans Whitaker
Bill D'Andrea, Athletic Director
Omar Rashed, Senior Vice President for Administration and Brand
Matt Finley, Senior Associate Athletic Director
Mark Vaughan, Associate Athletic Director, Development
Charlie Dickerson, Director of Facilities

Planning Team

Irene Dumas Tyson, AICP, Associate AIA
BOUDREAUX

Keith Richey, Associate AIA
BOUDREAUX

Joel Leider, RA
SportsPLAN Studio

Hoyt Burnett, PE
LandPlan South

WORKSHOP SCHEDULE

TUESDAY, MAY 9

11:00 am – 1:00 pm	Kick-off lunch meeting with Athletics Core Team and Planning Team
1:00 – 3:00 pm	Athletics Facilities Tour
3:30 – 4:30 pm	Meeting with key athletics staff and coaches
4:30 – 5:20pm	Meeting with City of Anderson and City of Anderson Parks & Recreation
5:30 – 6:00 pm	Debrief with Athletics Core Team
Evening	Planning Team Work Session

WEDNESDAY, MAY 10

9:00 – 9:50 am	Stakeholder/Coaches Meeting
10:00 – 10:50 am	Stakeholder Meeting
11:00 am – 3:00 pm	Planning Team Work Session
3:00 – 4:30 pm	Debrief with Athletics Core Team
Evening	Planning Team Work Session

THURSDAY, MAY 11

9:00 – 10:00 am	Debrief with Athletics Core Team
10:00 am – 3:00pm	Planning Team Work Session
3:00 – 5:00pm	Athletics Master Plan Presentation to Athletics Core Team and Key Stakeholders



Executive Summary

How can Anderson University Athletics reflect the successes and top tier academic rankings of a regionally and nationally recognized university? How can the University best recruit, support and retain top varsity athletes and coaches in order to create an athletics environment that is competitive? How can the Athletics Department build a growing legion of fans to support the development and the possibilities of the Trojan teams?

The BOUDREAUX team was tasked with this primary objective: to prepare an Athletics facility framework for future development, improvements, and program and donor enticements for Anderson University Athletics and Recreation Facilities.

To begin the planning process, the athletics leadership shared the critical needs as well as additional needs to meet in the future in order to build and sustain a top-tier varsity program. The needs are as follows.

Critical Needs

- Locker rooms at the athletic facilities with showers and air conditioning for fall and spring sports (except women’s and men’s tennis)
- Lights on the soccer field
- Running track with lights that can be used by the university and the community
- Increased practice fields
- Turf field for soccer and lacrosse (future)

Additional Needs

In addition, the university needs additional administrative and athletics facilities to support the coaches, management, fund development, and the physical development of the athletes. These additional facility improvements may include the following.

- New Athletics Center (administration offices, weight/strength training, Hall of Fame, museum)
- New baseball stadium
- Indoor tennis courts
- New intramural facilities
- Golf driving range and club house
- Renovation of the Abney Athletic Center

In order to meet the needs and to provide for future growth, the BOUDREAUX team recommends the following new facilities. These recommendations, which are further defined in this report, provide a path forward.

Summary of Programmed Spaces	Recommended GSF ¹
Varsity Team Support Facilities	43,293 GSF
Athletic Offices (Basketball and Volleyball coaches remain in the Abney)	8,967 GSF
Track and Field Stadium (1,500 seats, 9 lanes)	12,000 GSF
Baseball Stadium (1,500 seats)	20,400 GSF
Indoor Tennis Courts (4)	34,271 GSF
Recreation Gym and Pool	60,612 GSF
Golf Center	2,075 GSF
2,500 seat Arena (3,200 maximum capacity with chairs on the floor)	88,600 GSF

There is significant potential to build a world class varsity athletics program. These facilities can bring this potential to life.

Respectfully submitted,

The BOUDREAUX Team
Irene Dumas Tyson, BOUDREAUX
Keith Richey, BOUDREAUX
Joel Leider, Sports Plan Studio
Hoyt Burnett, LandPlan Group South

¹GSF: Gross Square Footage = usable space+grossing factor to include corridors, mechanical, restrooms, and other building support spaces

ANALYSIS

Existing Site Conditions
Existing Facilities Conditions
Summary of Stakeholder Input

Existing Site Conditions



Athletics Campus



Boundary of Soccer Field



Soccer Field



Detention Area



Williamston Road/Gossett Street



Practice Field



View from Williamston Road

Existing Site Conditions

The main athletic campus (the triangle) is about 44 acres. Anderson University (AU) purchased several parcels adjacent to the main athletic campus and fronting North Gossett Street, East Orr Street, Old Williamston Road, and Williamston Road. This brings the total athletic acreage AU owns including the surrounding parcels is 77 acres.

The site currently has a softball complex and a tennis complex that were completed in the last two years. There is also a cell tower near the tennis courts that cannot be moved. The softball complex is on the eastern side of the property and the tennis complex is on the western side of the complex. The soccer team is using an existing field and bleachers in the center of the athletic campus. There is a recreation gym next to the tennis complex, but this building is not conditioned and can get uncomfortably cold in the winter and extremely hot in the summer.

Other existing buildings are being used for facility services, classrooms, storage, and a weight lifting area. There are new parking lots to serve the tennis courts and softball field in addition to older asphalt pavement areas that are dedicated to student parking. There is an intramural field at the corner of East Orr Street and Williamston Road. The triangle has some significant changes in topography. From the highest point to the lowest point there is 52' of elevation change. When the tennis and softball complexes were built, detention ponds were added to the northern side of the triangle. Due to excessive slopes and detention ponds there are only about 36 acres of usable land out of the 44 total acres in the triangle.

Existing Site Conditions

The adjacent parcels along Old Williamston Road, and North Gossett Street have some steep slopes, creeks, wetlands, floodway areas and floodplain areas. The wetlands, floodway, and floodplain areas are associated with Cox Creek that runs along the eastern border of the property Anderson University owns. The floodplain area can be used for fields or parking lots. Any structure within the floodplain has to be built 1' above the 100 year flood elevation. The floodplain area accounts for about 10 acres. The floodway (about five acres) cannot be built on at all.

The exact location of the wetlands will have to be investigated further as the wetlands that appeared on the National Wetland Inventory maps did not match up with field conditions. Most, if not all, of the wetlands would be in the floodplain and floodway areas.

There is an abandoned railroad bed that is on the south side of the property south of Williamston Road. The railroad bed is grassed and traverses from North Gossett Street to East Orr Street.

Anderson University also owns some property on the east side of Cox Creek (not included as a part of this study area) that is designated as the Rocky River Conservancy. There are a series of trails in this conservancy area that stretch from Cox Creek to the Rocky River and Old Williamston Road and Williamston Road.



Gossett Street



View from practice field to Williamston Road



Gossett Street



Parking Area



Gossett Street



Tennis

Site Analysis

Buildable Area Breakdown



Unbuildable area: 14 acres/77 acres (18%)
(steep slopes, detention ponds, creek,
and floodway area)

Challenging areas, but usable: 10 acres/77 acres (13%)
(floodplain and wetlands)

Existing facilities to remain: 7 acres/77 acres (9%)
(tennis complex, softball complex and cell tower)

Therefore, 46 acres or 60% of the site can be developed
for the athletic campus and other university uses.



Legend	
	Unbuildable Area
	Existing Neighbors / Single Family Homes
	Roadways and Intersections
	Existing Facilities and Green Space
	Existing Single Family Homes

Existing Facilities Conditions

The Athletics Campus is primarily comprised of former Anderson County Fairgrounds sheds that have been retrofitted into offices, intramural basketball courts, weight training, indoor practice areas, and storage. The building that houses Athletics administration and the offices for campus facilities and maintenance is the only conditioned building of the four shed structures. There is a restroom building that serves the softball and soccer fields; however, this building is beyond efficient and functional capacity.

The shed used for indoor practice, strength training and some storage (athletics and maintenance) is in poor condition: insufficient lighting, poor air circulation, leaking roof, no HVAC or insulation. The athletes use the space as well as they can. The intramural building is used constantly and serves the athletes and students across campus as well as hundreds of K-12 students who participate in summer camps. The building is not conditioned, although fans are used in the summer to provide some air movement.

The smaller, open shed is used for intramurals, summer camps and events.

The softball field, tennis facility and swimming pool are new additions to the athletics campus. The softball field is a very nice facility; however, the orientation of the field is not ideal, and no locker rooms were provided for the athletes.



Intramural Gym



Weights



Athletic Campus



Softball



Softball



Softball



Intramural Gym



Pool



Soccer



Soccer



Soccer



Softball

The tennis facility has eight courts with the option to add four additional courts. The building houses coaches' offices, locker rooms for the women's and men's teams, and campus sports communications offices with public restrooms, concessions and storage on the lower level. The upper level is not ADA accessible. The swimming pool is adjacent to the tennis facility and is primarily a splash pool. The pool is used mostly by summer camp participants.

The soccer field conditions are not ideal, and the lack of lights limits game and practice schedules. However, the school is in the process of adding lights.

There is no baseball field or track and field facility. This requires the university to rent the City of Anderson's baseball field and to rent the use of the track at T.L. Hannah High School. In addition, the university frequently rents soccer fields from the Anderson County Sports and Entertainment Center. The lack of locker rooms on the athletics campus limits team building among the varsity athletes and is not very welcoming to visiting teams.

While this workshop focused on the athletics campus, the team did walk through the Abney. The team recommends that the University move forward with planned renovations and, in the future, perform a detailed feasibility study of the Abney in order to address accessibility, HVAC systems, space utilization, aesthetics, and how to better integrate the building with the new Ross Center green space.

In short, the condition of the athletics facilities has a negative impact on the University's ability to recruit and retain top athletes and coaches. Anderson University is one of the top university's in the South Atlantic Conference and, therefore, should have the facilities to support its standings and to make it more competitive in NCAA Division II Athletics.



Abney

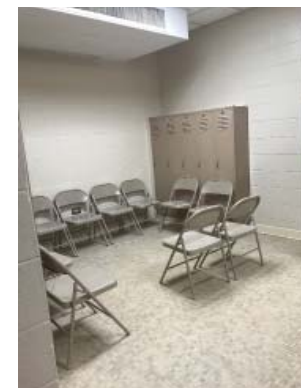

Abney



Abney



Abney



Abney

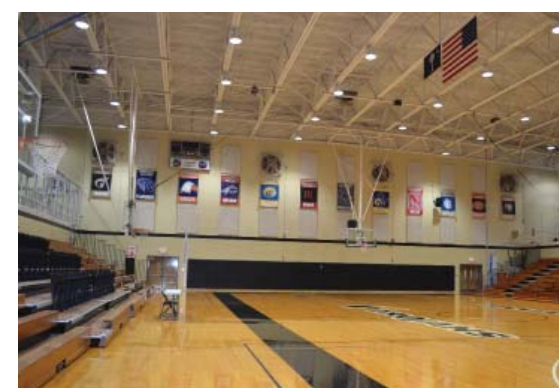

Abney

Summary of Stakeholder Input

Summary of Stakeholder Input

The planning team gathered invaluable information and ideas through a series of interviews and focus groups with university and athletics leadership. The administration and coaches shared challenges to operations and recruitment, but had numerous ideas for improving the athletics facilities for both varsity athletes and student recreation and intramurals.

Guiding Principles

Through stakeholder interviews, the following principles were created to guide future development of the athletics campus. These principles represent the values of Anderson University Athletics and can ensure that the campus develops in a way that enhances not only athletics, but the entire university and the surrounding community.

- Campus as park: beautiful and well-maintained landscapes, shade, places to gather or sit quietly
- Connectivity: pedestrian focus, connect to City of Anderson greenways and sidewalks, Parking on perimeter
- Security and controlled access
- Nice aesthetics: grounds, design details, gateways, fences, lighting, site amenities
- Boulevard Street as a tree-lined boulevard
- Integrate athletics with campus life: athletic campus for all students, welcoming, accessible
- Correct orientation (sun and wind) of all fields
- Athletic facilities and services to support student athletes to compete and excel spiritually, academically, athletically, physically

Wish List for Athletic Facilities

- Interim improvements to the Abney
- Multi-purpose arena to replace the Abney: 2,500 seats for basketball and up to 3,200 for concerts and commencements
- Baseball stadium: 1,500 seats
- 4 new indoor tennis courts
- Softball improvements: covered batting cages, covered seating, infield practice field
- Track with 9 lanes: 1,500 permanent seating with space for supplemental special event seating; can have a Soccer or Lacrosse field on the infield.
- Golf: driving range and/or short iron range
- Recreational gym replacement
- Aquatics with lap pool
- Trails throughout the athletic campus and that connect to the university and city

Improvements for All of Athletics

- Strength center (5,000 SF interim move is OK for now, but the master plan recommendation for the future includes a 7,000 square foot strength and conditioning center to accommodate the potential addition of a Men's Lacrosse program).
- Locker rooms for all sports: women and men (except Golf), visiting teams, staff and officials
- Meeting/classrooms: can be shared
- Laundry and equipment management
- Athletic training center to serve all AU teams
- Athletic offices and administration with Hall of Fame/ Legacy features

Opportunity to create a unified campus



RECOMMENDATIONS

Summary of Recommended Facilities
Facilities Analysis
Recommended Master Plan
Recommended Phasing and Priorities
Design Concepts
Recommended Facilities Space Program

Summary of Recommended Facilities

Facilities Program Summary: Detailed Facilities Space Programs begin on page 29.

PROJECT	GSF	REMARKS
Phase One		
Varsity Team Facilities	43,293 GSF	GSF Conditioned Space
Athletic Department Offices	8,967 GSF	GSF Conditioned Space
1,500 Seat Track and Field Stadium	12,000 GSF	GSF Conditioned Space
Recreation Gym and Natatorium	60,612 GSF	Replaces existing metal building
Phase One Subtotal	124,871	
Phase Two		
1,500 Seat Baseball Stadium	20,400 GSF	GSF Conditioned Space
Indoor Tennis Courts	34,271 GSF	GSF Conditioned Space
Phase Two Subtotal	54,671	
Phase Three		
Varsity Golf Center	2,075 GSF	GSF Conditioned Space
Future 2,500 Seat Multipurpose Events Center	88,600 GSF	GSF Conditioned Space
Phase Three Subtotal	90,675	

SportsPLAN Studio in association with BOUDREAUX

University Feedback

Through discussion with various Anderson University stakeholders, it became apparent that the site would need to accommodate several other uses for the overall University in addition to its athletic facilities. These include the following:

- Student Parking
- Facility Services
- Residential Housing
- Interconnectivity
- Intramural Activities

Facilities Analysis

Athletics Administration

One of the first projects proposed for the Athletic Campus is a building that will provide locker rooms, athletic department offices, meeting rooms/classrooms, a strength training center, an athletic training center and laundry and equipment management spaces to benefit all varsity athletic programs except basketball and volleyball, which will remain in the Abney for a period to be determined.

Baseball

In order to inform discussions of baseball field orientation, the master plan team prepared sun angle studies of a proposed new baseball stadium illustrating the sun's effect on the comfort and safety of baseball players, the home plate umpire and spectators. The Team explored field orientation options with the baseball coach and selected a preferred field orientation which has late afternoon sunlight falling on the field generally perpendicular to the centerline of the field-of-play during the spring baseball season.

Images included in this document illustrate the angle of sunlight on a baseball field at 5:00 P.M. local time at various dates in the baseball season on February 01, March 01, April 01 and May 01 and illustrate the selected field orientation relative to the orientation of the existing Softball stadium. The 5:00 P.M. time was chosen to consider the effect of low-angle sunlight at the end of an afternoon practice or in the late innings of an afternoon game.

Recommended Baseball Field Orientation

FEBRUARY 1: 5PM EST

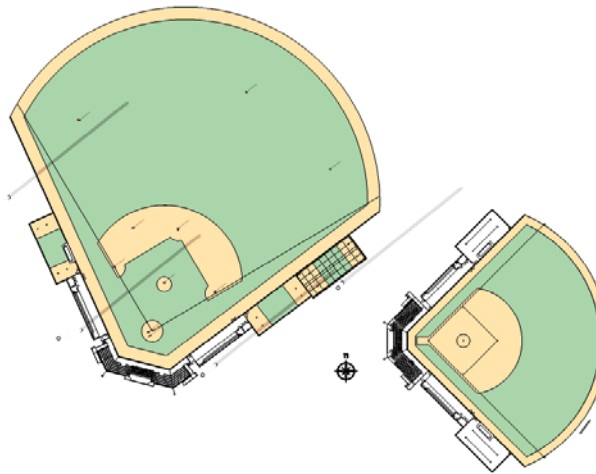

MARCH 1: 5PM EST

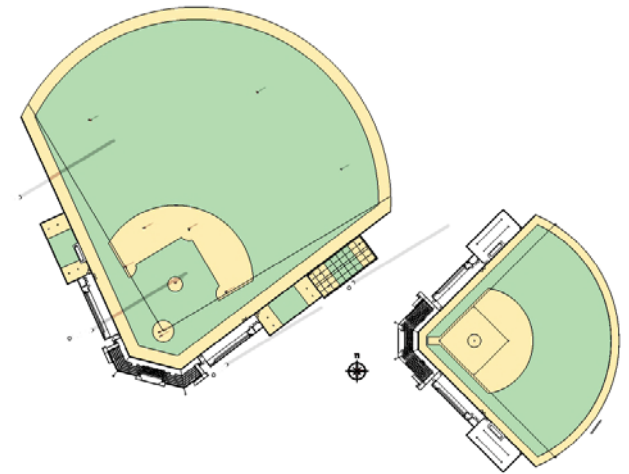

APRIL 1: 5PM EST

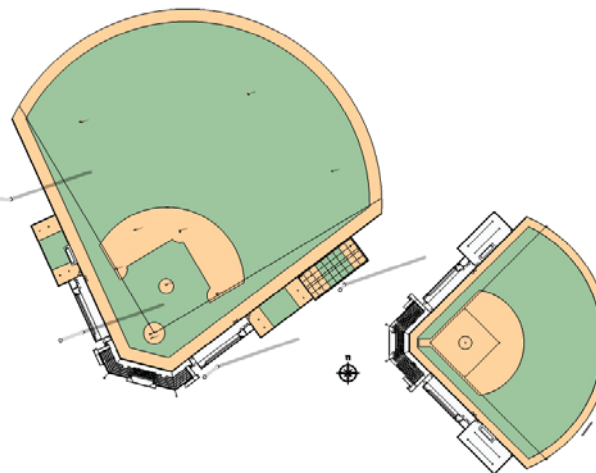

MAY 1: 5PM EST

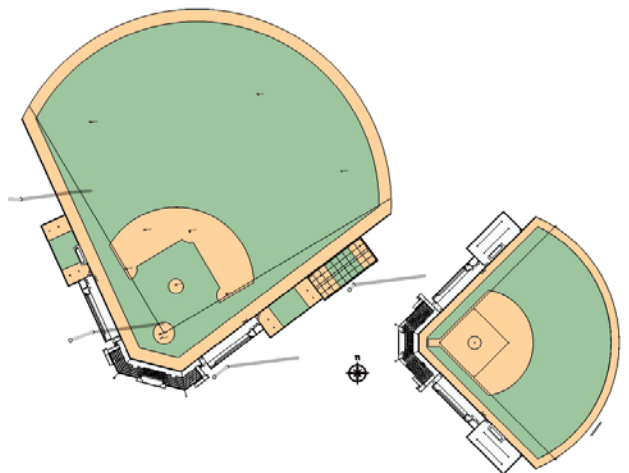

Track & Field Orientation Analysis

**Wind Rose for Anderson County Airport (KAND)
Feb. 1, 2016 to Feb. 28, 2016**

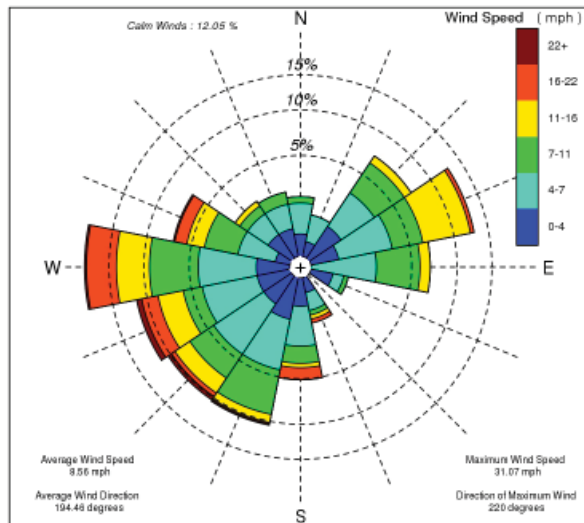

**Wind Rose for Anderson County Airport (KAND)
Mar. 1, 2016 to Mar. 31, 2016**

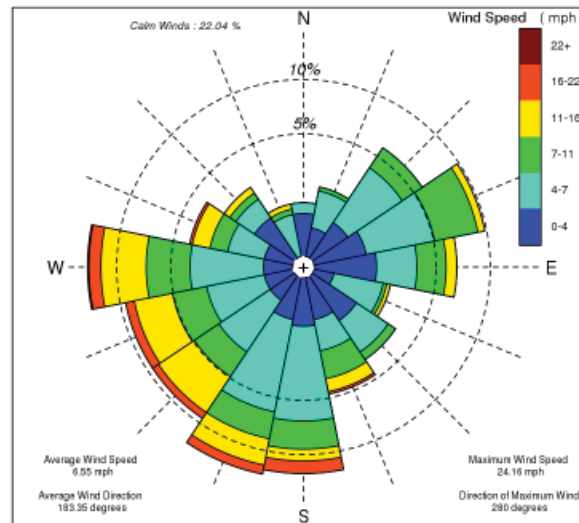

**Wind Rose for Anderson County Airport (KAND)
Apr. 1, 2016 to Apr. 30, 2016**

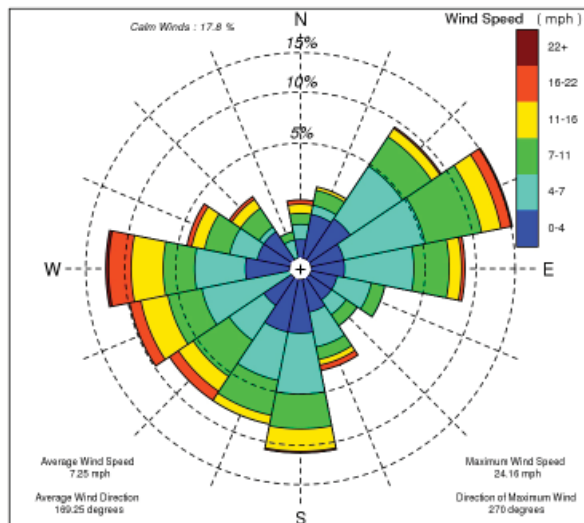

**Wind Rose for Anderson County Airport (KAND)
May. 1, 2016 to May. 31, 2016**

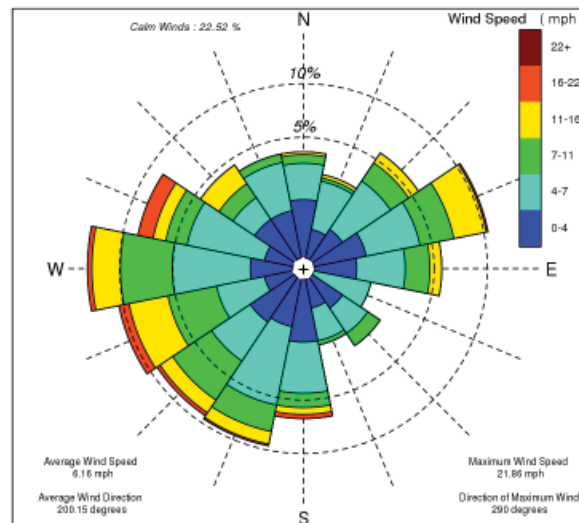

Track and Field

For the proposed track and field stadium, the primary orientation concern of the AU track coach is to have prevailing spring winds blowing at the backs of runners on the final straightaway. Local wind roses for the spring months indicate prevailing winds are from the southwest. A secondary concern, since the synthetic turf infield must accommodate a new soccer and/or lacrosse field is the effect of late afternoon sunlight on the comfort of goal keepers. Thus, the preferred stadium orientation is illustrated with the longitudinal axis of the track and infield at approximately the 1:00 o'clock to 7:00 o'clock positions.

Wind is also an important concern for jumping events and the pole vault. Subsequent design activities must delve deeper into this issue to provide flexibility for staging those events with varying wind direction.

This recommended layout, as illustrated on p. 21, has the stadium grandstand and press box facing the late afternoon sun, which is not ideal of course, but these features traditionally coincide with position of the finish straightaway.

The track is to provide nine lanes, and because the infield must accommodate other sports activities, the track configuration included in the site plan illustration has a simple turn radius of 39.6 meters to accommodate a soccer field of NCAA optimum 75 yards width or a Women's Lacrosse field of NCAA maximum 70 yards width inside the track.

Recreational Gymnasium & Natatorium

In order to create space for other proposed improvements, the existing recreational gymnasium building is to be replaced with a new structure providing three multipurpose courts, space for indoor varsity team practice activities and related support functions. The concept plan and program and conceptual plan diagram for this building also adds an indoor eight lane x 25-yard swimming pool, locker rooms and other support functions to accommodate recreational aquatics, fitness lap swimming and potentially the addition of a future competitive swimming program. The director of the City of Anderson Parks and Recreation suggested an aquatics facility would be a possible opportunity for a City/University partnership.

Tennis

While the AU tennis complex was designed to accommodate four additional outdoor courts, the tennis coach advised that four indoor courts would be much more beneficial. The site plan illustrates a new tennis building with four indoor tennis courts and a small number of spectator seats. This project may be another good opportunity for a City/University partnership.

Golf

At the northeast corner of the site, the site plan includes a short irons golf range with chipping and putting greens and a varsity golf center with some dedicated parking spaces and indoor space for a golf team lounge/meeting space, an indoor swing analysis lab and other support functions.

Multipurpose Arena

The largest and most costly feature of the Athletics Campus master plan is a future multi-purpose arena or events center that would someday replace the arena function of the Abney. This project may be another good opportunity for a City/University partnership.

Site Development Options

The biggest challenge with the site is making sure the fields are in the best possible orientation to avoid inopportune sun angles for soccer, baseball and tennis (additional 4 courts) and a possible lacrosse field. The track also needs to be oriented so the prevailing wind will be at the runner's back when the runners make the last turn headed to the finish line.

The team explored a few site options that insured the best possible orientation for fields. The final recommended master plan follows.

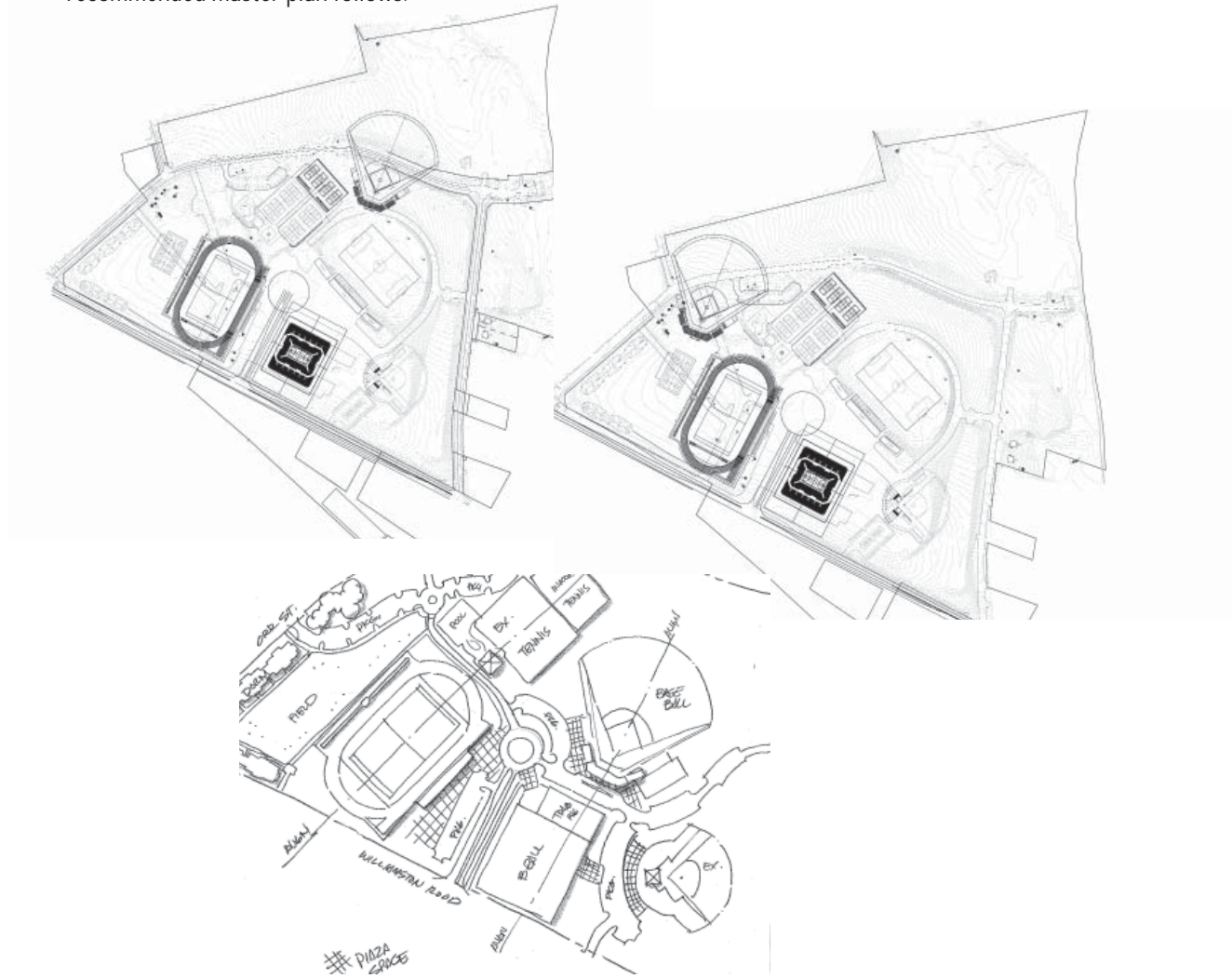

Recommended Master Plan

The master plan illustrates the long-term development of the athletics campus and represents the vision of university leadership.



Recommended Phasing and Priorities

Master Plan implementation is best accomplished through phases. This provides the university the time to build support and potential partnerships, to plan and design facilities, to understand the capital investment needs, and to stage construction in a way that decreases disruptions to academics and the athletics schedules. As projects are completed, the team recommends that the university regularly update the master plan to ensure future needs are met.

Next Three Months

- Core Team: reach consensus on priorities and the recommendations of the Athletics Master Plan concepts
- Create a committee (Anderson University leadership and City of Anderson leadership) to begin discussions and work plan for potential joint ventures on projects that serve the university and residents of Anderson. This committee should establish a mission and a timeframe for recommending potential projects.
- Possible Partnerships Include:
 - Greenways and shared paths
 - Boulevard Street corridor and intersection improvements
 - Track and Field Stadium
 - Tennis courts (4, potentially indoor)
 - Aquatics Center/Natatorium
 - Old Williamston Road closure at Gossett
 - Enhancements to the Rocky River Park Conservancy
 - Multi-purpose arena/performance center
- Based on confirmed priorities and with the appropriate consultants, moved forward with necessary planning, feasibility studies and design of projects in order to establish conceptual construction budgets, schedules, potential donors and funding sources and to integrate projects in the university's development and capital planning efforts.
- Consider possible naming opportunities for the athletics campus

Phase I Projects

- Based on university/city committee consensus and recommendations:
 - Enhance Boulevard Street intersections at Orr and Gossett: pedestrian crosswalks, improved sidewalks/bike paths, mast arm light fixtures, banners, landscaping
 - Begin planning and/or construction of the proposed University Loop shared path (City of Anderson Parks and Recreation 2017 Master Plan)
 - Begin planning and/or construction of the proposed Founders Heritage Trail (City of Anderson Downtown Bicycle and Pedestrian Connectivity Plan, 2014)
- Construct gateways on Boulevard Street at Orr and Gossett
- Hire consultant team to produce comprehensive, detailed plan of the Athletics Campus and schematic designs for the new entrance and Phase I infrastructure, a new facilities and maintenance complex (consider use of modular/portable buildings for schedule and financial flexibility) , and a new Athletics Administration and Services Building. This will inform the capital campaign needs and provide the collateral for fundraising.
- Move forward on planned improvements to the Abney

Phase II Projects

- Facilities and maintenance relocate to new complex
- Construct parking for students in newly acquired property across from the athletics campus on Boulevard Street: design elements to include fencing, secured/controlled access, covered trolley stop (lighting, emergency call box), signage, pedestrian crossings
- Construct new entrance to athletics campus and new parking: gateway, signage, landscaping, lighting. New parking will be phased per construction phases.
- Improve recreation/intramural fields along Old Williamston Road

Phase III Projects

- Construct new Athletics Administration and Services Building
- Design new track and field/soccer stadium
- Design new baseball field
- Demolish existing facilities/athletics administration barn

Phase IV Projects

- Construct new track and field/soccer stadium
- Update the Athletics Master Plan

Design Concept: Pedestrian & Bicycle Connectivity

Improving pedestrian and bicycle connectivity between the athletics campus and the main campus will create a more unified campus and sense of community. Sidewalk improvements, new multi-use pathways around and through the campus also will provide accessible and welcoming paths for recreation and wellness for the Anderson University family as well as the City of Anderson.

Places to Connect

- Main Campus to Athletics Campus
- City of Anderson Parks and Recreation Master Plan 2017 - proposed pathways
- Rocky River Nature Park
- City of Anderson Downtown Bicycle and Pedestrian Connectivity Plan, 2014 - proposed pathways

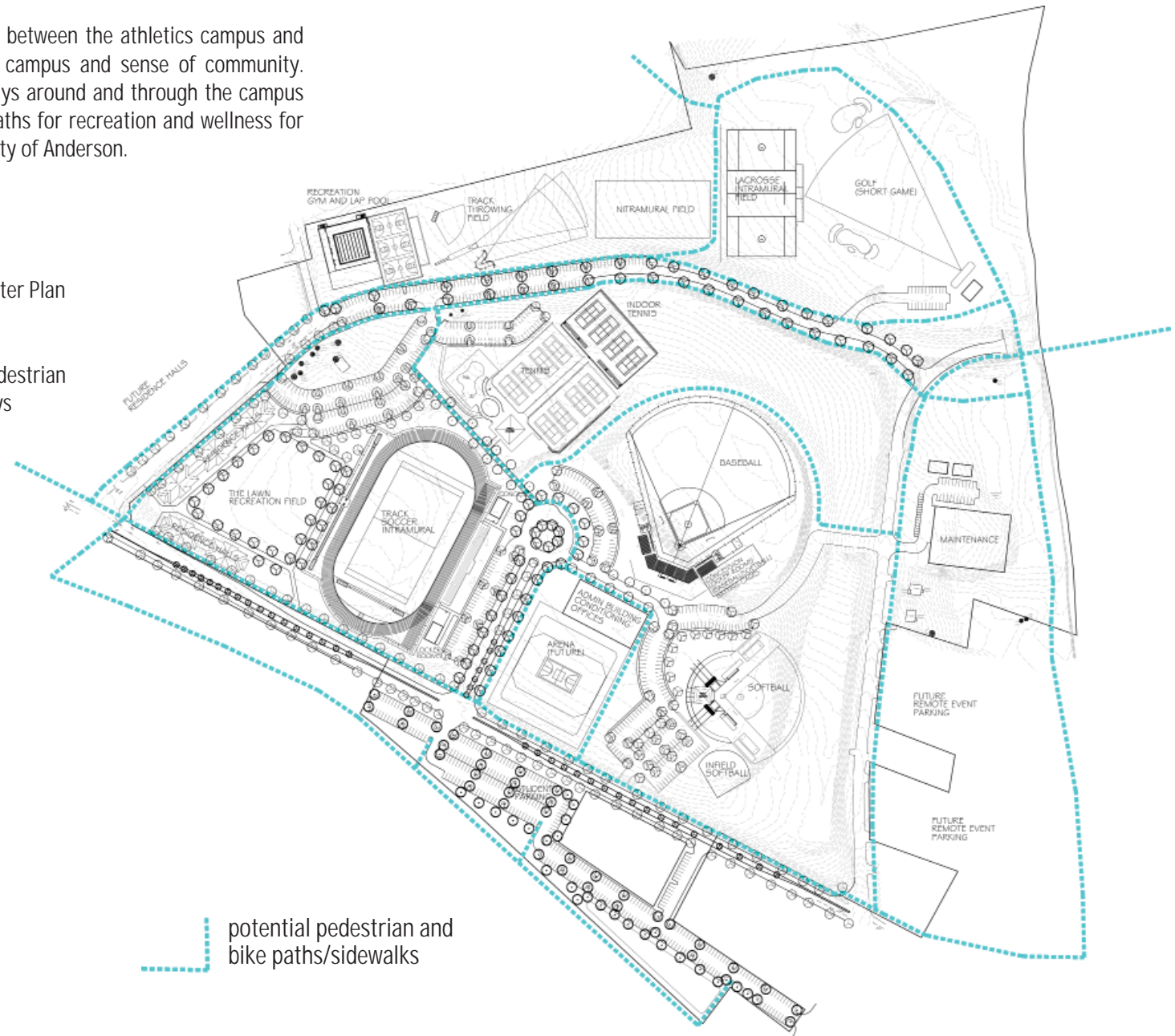

Design Concept: Williamston Road

Williamston Road is the gateway to Anderson University, particularly the athletics campus. Williamston Road can announce that one is entering a special community and can promote athletics and academics. The following concepts illustrate the potential of creating a beautiful gateway into the university. Improvements to Williamston Road can incorporate university banners, landscaping, and enhanced pedestrian and bike safety and accessibility.

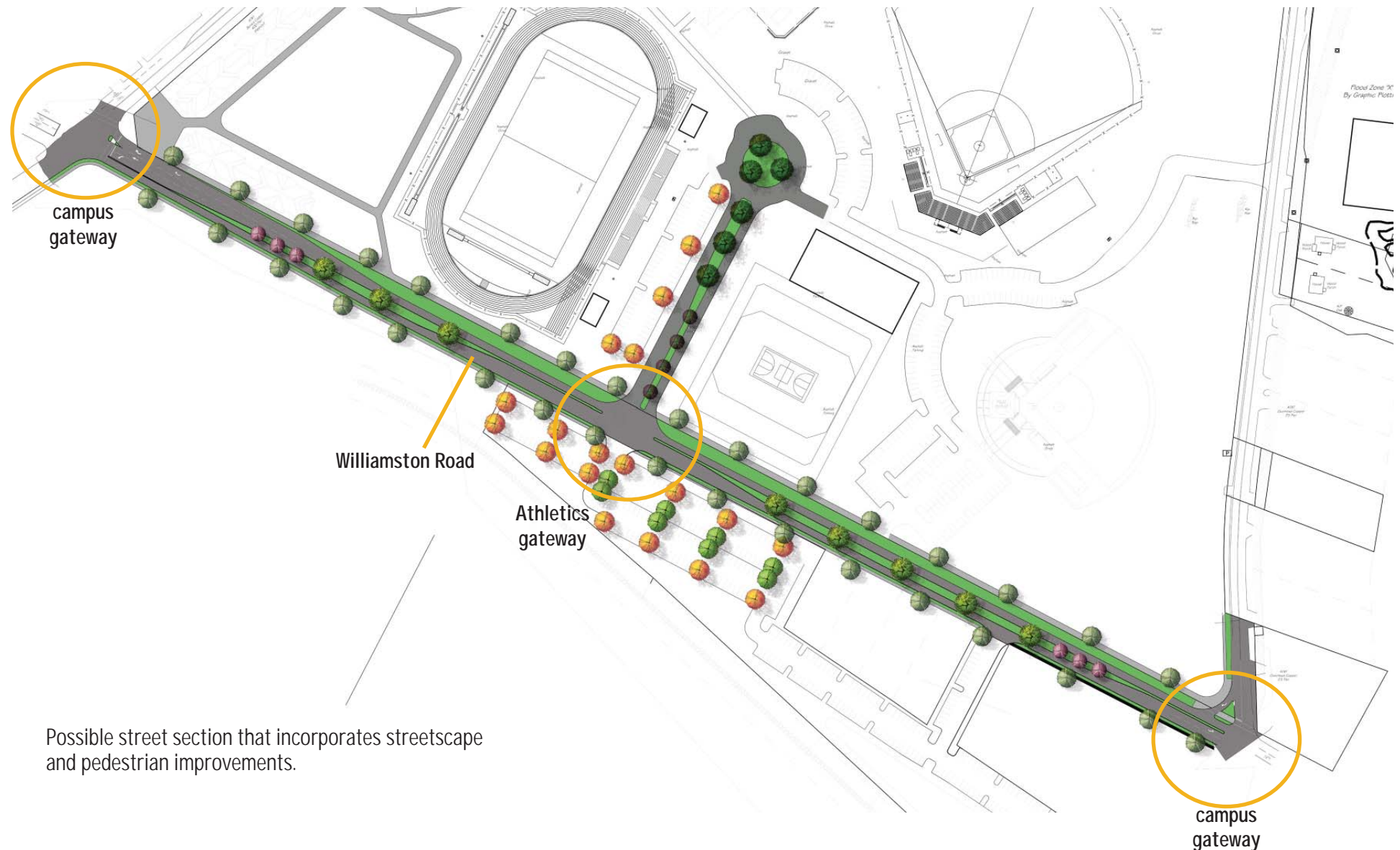

Williamston Road Street Section Concepts



Possible street sections that incorporates streetscape and pedestrian improvements.



Intersection Williamston Road at Orr Street Existing

Design Concept: Williamston Road at Orr Street

This intersection can become a beautiful gateway to the athletics campus. Adding pedestrian crosswalks, signage, landscaping and lighting will convey that this is a college campus thereby creating a safer and more accessible environment for students. This site is suited for additional buildings, such as residential and academics, that can further unify the university campus.



Williamston Road at Orr Street Recommended Improvements

Design Concept: Williamston Road at Gossett Street

This intersection is the first impression and welcome for many traveling to Anderson University. Landscaping, signage and crosswalks will communicate that travelers are entering a beautiful college campus.



Intersection at Gossett Street Existing



New Gateway Sign at Gossett Street Recommended Improvements



Existing Athletics Campus Entrance

Design Concept: Athletic Campus Gateway on Williamston Road

Announcing the athletic campus from Williamston Road will welcome visitors and potential recruits and students. This will create a positive impression for the university and a special sense of place for athletics.



Athletics Campus Gateway Recommended Improvements

Recommended Facilities Space Program

The following charts detail the spaces (size and quantities) needed for each facility in order to meet the vision of the long-term growth and development of Anderson University Athletics. The program will need to be updated as master plan implementation continues, but this provides an order-of-magnitude view of the facilities' needs.

Varsity Team Support Facilities

VARSITY TEAM SUPPORT FACILITIES - PROGRAM SPACE				NASF ²	REMARKS
A. Athletic Training					
A.	1.	Head Athletic Trainer's Office		120	
A.	2.	Assistant Trainer's Office		100	
A.	3.	Assistant Trainer's Office		100	
A.	4.	Graduate Assistant Trainer's Office		120	Two work stations
A.	5.	Conference Room		196	
A.	6.	Office / Examination Room		120	
A.	7.	Office / Examination Room		120	
A.	8.	Office / Examination Room		120	
A.	9.	Taping Area		400	5 taping benches
A.	10.	Treatment Area		450	6 treatment tables of two sizes
A.	11.	Rehabilitation Area		500	
A.	12.	Hydrotherapy		600	3 whirlpools, rinse station, ice machines, sink
A.	13.	Self Serve Ice Distribution		40	
A.	14.	Unisex toilet / dressing room		80	
A.	15.	Ready Storage		140	
A.	16.	Service Garage		140	parking for gator or golf cart
A.	17.	Book Bag Storage		50	cubbies
Subtotal - Athletic Training				3,396	NASF

²NASF - Net Assignable Square Footage = usable space

SportsPLAN Studio in association with BOUDREAUX

VARSITY TEAM SUPPORT FACILITIES - PROGRAM SPACE				NASF	REMARKS
B. Strength and Conditioning					
B.	1.	Weight Room		7000	refer to Strength and Conditioning Equipment Space Planner
B.	2.	Strength Coach Office		120	
B.	3.	Equipment Storage and Repair		150	
Subtotal - Strength and Conditioning				7,270	NASF
C. Meeting Rooms					
C.	1.	Team Meeting Room A		800	may have operable partitions
C.	2.	Team Meeting Room B		800	may have operable partitions
C.	3.	Team Meeting Room C		600	may have operable partitions
C.	4..	Furniture Storage		180	
Subtotal - Meeting Rooms				2,380	NASF
D. Athletic Equipment					
D.	1.	Equipment Storage and Repair		1,000	
D.	2.	Uniform and Equipment Preparation		200	
D.	3.	Uniform and Equipment Distribution		300	
D.	4.	Receiving Room		200	directly adjacent to truck dock or off-loading
D.	5.	Laundry Room		700	Washers: 2@75#, 1@35# Dryers: 2@75# 1@50#, soak sink
D.	6.	Equipment Manager Office		100	
D.	7.	Student Staff Office		120	two work stations
Subtotal - Athletic Equipment				2,620	NASF

Recommended Facilities Space Program

Varsity Team Support Facilities

VARSITY TEAM SUPPORT FACILITIES - PROGRAM SPACE			NASF	REMARKS
E. Locker Rooms (Basketball and Volleyball locker rooms remain in Abney until future arena project)				
E.	1.	Baseball Team Dressing Room	840	45 lockers @ 18" x 18" x 84" - upsize catchers' lockers
E.	2.	Women's Lacrosse Team Dressing Room	600	30 lockers @ 18" x 18" x 84"
E.	3.	Men's Lacrosse Team Dressing Room	1,080	45 lockers @ 24" x 24" x 84"
E.	4.	Women's Soccer Team Dressing Room	600	28 lockers @ 18" x 18" x 84"
E.	5.	Men's Soccer Team Dressing Room	640	28 lockers @ 18" x 18" x 84"
E.	6.	Softball Team Dressing Room	500	25 lockers @ 18" x 18" x 84" - upsize catchers' lockers
E.	7.	Women's Track and Cross Country Dressing Room	850	50 lockers @ 18" x 18" x 84"
E.	8.	Men's Track and Cross Country Dressing Room	850	50 lockers @ 18" x 18" x 84"
E.	9.	Women's Shared Shower/Toilet Room	1200	16 shower stalls, 10 waterclosets, 10 lavatories
E.	10.	Men's Shared Shower/Toilet Room	1000	16 shower heads, 4 waterclosets, 4 urinals, 6 lavatories
E.	11.	Female Coaches/Staff Dressing Room	440	24 lockers @ 18" x 18" x 84"
E.	12.	Female Coaches/Staff Shower/Restroom	500	4 shower stalls, 3 waterclosets, 3 lavatories
E.	13.	Male Coaches/Staff Dressing Room	600	36 lockers @ 18" x 18" x 84"
E.	14.	Male Coaches/Staff Shower/Restroom	600	6 shower stalls, 2 waterclosets, 2 urinals, 3 lavatories

VARSITY TEAM SUPPORT FACILITIES - PROGRAM SPACE			NASF	REMARKS
E. Locker Rooms (Basketball and Volleyball locker rooms remain in Abney until future arena project)				
E.	15.	Visiting Team A Dressing Room (capacity 50)	750	Continuous bench, shelf and hanging rod
E.	16.	Visiting Team A Shower/Toilet Room	680	8 shower heads, 2 waterclosets, 3 urinals, 4 lavatories
E.	17.	Visiting Team B Dressing Room (capacity 30)	480	Continuous bench, shelf and hanging rod
E.	18.	Visiting Team B Shower/Toilet Room	540	6 shower heads, 2 waterclosets, 2 urinal, 3 lavatories
E.	19.	Visiting Team C Dressing Room (capacity 20)	340	Continuous bench, shelf and hanging rod
E.	20.	Visiting Team C Shower/Toilet Room	480	4 shower heads, 2 waterclosets, 1 urinal, 2 lavatories
E.	21.	Female Officials' Dressing Room	180	6 lockers @ 15 x 18" x 60"
E.	22.	Female Officials' Shower/Toilet Room	260	2 showers, 2 waterclosets, 2 lavatories
E.	23.	Male Officials' Dressing Room	180	6 lockers @ 15 x 18" x 60"
E.	24.	Male Officials' Shower/Toilet Room	260	2 showers, 1 watercloset, 1 urinal, 2 lavatories
E.	25.	Officials' Common Room	180	
Subtotal - Locker Rooms			14,630	NASF
Subtotal Net Area Requirements			30,296	NASF
Circulation, mechanical, chases, wall thickness			12,997	70% Efficiency
Grand Total Gross Area Requirement			43,293	GSF

SportsPLAN Studio in association with BOUDREAUX

Recommended Facilities Space Program

Varsity Team Support Facilities - Strength and Conditioning Equipment Space Planner

			QTY	Width (in.)	Length (in.)	NSF / Station	Plan SF
Cardiovascular Equipment							
CV	1.	Upright Bike	2	21	44	7	42
CV	2.	Recumbent Bike	0	27	65	13	0
CV	3.	Stepper	0	32	50	12	0
CV	4.	Treadmill	0	37	80	21	0
CV	5.	Elliptical Cross Trainer	0	32	80	18	0
CV	6.	Adaptive Motion Trainer	2	35	80	20	120
CV	7.	Rowing Machines	0	39	102	28	0
CV	8.	Ab Stretcher	2	28	52	11	66
CV	9.	Upper Body Ergometer	1	30	60	13	39
Subtotal - Cardiovascular Equipment			7				267
Free Weights							
FW	1.	9' Half Racks with inset platforms	10	96	128	86	3,440
FW	2.	Ground-Based Jammer	2	59	66	28	224
FW	3.	Multi-Adjustable Bench	4	53	32	12	192
FW	4.	Flat Dumbbell Bench	4	22	50	8	128
FW	5.	Glute/Ham Bench with Reverse Hyperextension Handle	4	33	72	17	272
FW	6.	Plate-Loaded Leg Press Machine	2	65	95	43	344
FW	7.	Cable Lat Pulldown/Seated Row	2	50	79	28	224
Subtotal - Free Weights and Plate Loaded			28				4,824
Plyometrics and Agility Training							
P	1	Movement and Agility Training Space	-	-	-	-	1,200
Subtotal - Plyometrics and Agility Training							1,200

SportsPLAN Studio in association with BOUDREAUX

			QTY	Width (in.)	Length (in.)	NSF / Station	Plan SF
Accessories							
A	1.	Lever-Action Benches for Racks	10	-	-	-	-
A	2.	Plate Storage Racks		-	-	-	-
A	3.	3-Tier Dumbbell Racks		31	90	20	0
A	4.	Dumbbell Sets of 5lbs-150lb		5 lb	150 lb		
A	5.	Kettle Bells and Rack	2	25	54	9	56
A	6.	Power Lifting Bars	10	-	-	-	-
A	7.	Deadlift Bars	10	-	-	-	-
A	8.	EZ Curl Bars	10	-	-	-	-
A	9.	Weight Plates		2.5 lb	45 lb		
A	10.	Collars (Pair)		-	-	-	-
A	11.	Exercise Bands and Chains	10	-	-	-	-
A	12.	Ab Straps (for use on racks)	10	-	-	-	-
A	13.	TRX Suspension Trainer (for use on racks)	10	-	-	-	-
A	14.	Speed Band Stations	2	60	240	100	200
A	15.	Speed Sleds	2	23	38	6	24
A	16.	Weight Sleds	2	24	40	7	27
A	17.	Battle Ropes-Pairs	2	60	240	100	200
A	18.	Plyo boxes		-	-	-	20
A	19.	Medicine Balls and Rack	2	30	30	7	28
A	20.	Physio Balls and Rack	2	30	96	20	80
A	21.	Vertimax	0	-	-	-	0
A	22.	Wall-Mounted Belt Racks	2	-	-	-	10
A	23.	Chalk Holder	2	-	-	-	10
A	24.	Bar Racks	2	32	32	8	48
A	25	Sound System Component Rack	1	-	-	-	6
Subtotal - Accessories							709
Total							7,000

Recommended Facilities Space Program

Varsity Team Support Facilities

ATHLETIC OFFICES - PROGRAM SPACE			NASF	REMARKS
A. Athletic Administrative Offices				
A.	1.	Administrative Assistant/Reception/Waiting	200	
A.	2.	Assistant to the Director Office	120	
A.	3.	Athletic Director Office	180	
A.	4.	Director's Conference Room	160	6 person capacity
A.	5.	Senior Associate Athletic Director Office	140	
A.	6.	Associate Athletic Director Office	140	
A.	7.	Assistant Athletic Director Office	140	
A.	8.	Assistant Athletic Director Office-SID	140	
A.	9.	Assistant SID	120	
A.	10.	Student Work Study Office Space	120	two workstations
A.	11.	Small Conference Room	250	10 person capacity
A.	12.	Administration Copy/Workroom	100	
A.	13.	File Storage	120	
A.	14.	Coat Closet	40	
A.	15.	Staff Restroom	60	
Subtotal - Athletic Administrative Offices			2,030	NASF

ATHLETIC OFFICES - PROGRAM SPACE			NASF	REMARKS
B. Coaches' Offices (Basketball and Volleyball offices remain in Abney until future arena project)				
B.	1.	Baseball Head Coach Office	120	
B.	2.	Cheerleading Head Coach Office	120	
B.	3.	Golf Head Coach Office	120	
B.	4.	Women's Lacrosse Head Coach Office	120	
B.	5.	Men's Lacrosse Head Coach Office	120	
B.	6.	Women's Soccer Head Coach Office	120	
B.	7.	Men's Soccer Head Coach Office	120	
B.	8.	Softball Head Coach Office	120	
B.	9.	Tennis Head Coach Office	120	
B.	10.	Track/Cross Country Head Coach Office	120	
B.	11.	Volleyball Head Coach Office	120	
B.	12.	Shared Work Space for Assistant Coaches/Grad Assistants	960	24 cubicles
B.	13.	Video Server and Editing Workstation	150	
B.	14.	Video Equipment Storage	100	
B.	15.	Coaches' Conference Room/Staff Meeting Room	480	24 person capacity
B.	16.	Staff File /Copy /Work Room	150	
B.	17.	Staff Lounge with Kitchenette	200	
B.	18.	Coat Closet	40	
B.	19.	Women's Staff Restroom	200	3 waterclosets, 2 lavatories
B.	20.	Men's Staff Restroom	200	2 waterclosets, 1 urinal, 2 lavatories
Subtotal - Coaches' Offices			3,800	NASF
Subtotal Net Area Requirements			5,830	NASF
Circulation, mechanical, chases, wall thickness			3,137	65% efficient
Grand Total Gross Area Requirements			8,967	GSF

SportsPLAN Studio in association with BOUDREAUX

Recommended Facilities Space Program

New Track and Field Stadium

1,500 SEAT TRACK AND FIELD STADIUM - PROGRAM SPACE			NASF	REMARKS
A. Spectator Services				
A.	1.	Stadium Box Office	200	3 points-of-sale
A.	2.	Food and Beverage Stand(s)	840	6 points-of-sale
A.	3.	Food and Beverage Dry Storage	160	
A.	4.	First Aid Room/Spectator Services	180	
A.	5.	Women's Restroom(s)	1,200	approximately 19 water closets, 5 lavatories - confirm code requirements
A.	6.	Men's Restroom(s)	600	approximately 4 water closets, 6 urinals, 4 lavatories - confirm code requirements
A.	7.	Family Restroom A	80	1 water closet, 1 lavatory
A.	8.	Family Restroom B	80	1 water closet, 1 lavatory
A.	9.	Merchandise Sales	240	3 points-of-sale
A.	10.	Merchandise Storage	50	
Subtotal - Spectator Services			3,630	NASF

1,500 SEAT TRACK AND FIELD STADIUM - PROGRAM SPACE			NASF	REMARKS
B. Press Box				
B.	1.	Elevator Lobby/Hospitality Area	300	Capacity 20 people
B.	2.	Working Press, Statisticians and OPS Staff	300	10 working positions @ 30" min.
B.	3.	Broadcast Booth A	110	3 people
B.	4.	Broadcast Booth B	110	3 people
B.	5.	Public Address Booth	110	3 people
B.	6.	Meet Management	180	3 people
B.	7.	Video Board Control and Production	140	3 people
B.	8.	Voice/Data Equipment Room	40	
B.	9.	Sound and Video Equipment Room	100	component racks
B.	10.	Food and Beverage Service	160	Microwaves, sinks, refrigerators, warming carts, ice machine, warming oven, counter
B.	11.	Printer/Copier/Staff Work Room	100	
B.	12.	Women's Restroom	170	3 water closets, 2 lavatories-confirm code requirements
B.	13.	Men's Restroom	160	1 water closet, 2 urinals, 2 lavatories-confirm code requirements
B.	14.	Domestic Hot Water	40	
B.	15.	Air Handler	240	Appropriately distributed
B.	16.	Electrical Panel Room	60	
B.	17.	Custodian and Supply Storage	100	mop sink
B.	18.	Rooftop Videographer Position	200	
Subtotal - Stadium Press Box			2,620	NASF

SportsPLAN Studio in association with BOUDREAUX

Recommended Facilities Space Program

New Track and Field Stadium

1,500 SEAT TRACK AND FIELD STADIUM - PROGRAM SPACE			NASF	REMARKS
C. Stadium Operations				
C.	1.	Field Level Toilet Rooms	100	Two at 50 SF each
C.	2.	Electrical Panel Room	50	for Spectator Services buildings(s)
C.	3.	Field Lighting Control Room	100	
C.	4.	Concourse Custodian and Supply Storage	100	mop sink
C.	5.	Sports Equipment Storage	1800	
Subtotal - Stadium Operations			2,150	NASF
Total Net Conditioned Space			8,400	NASF
Horizontal circulation, mechanical, chases, partitions			3,600	70% Efficiency
Grand Total Gross Conditioned Space			12,000	GSF
D. Exterior Spaces				
D.	1	Picnic Plaza	1,500	Space for 50 at picnic tables, lawn chairs or 4Tops™
D.	2	Spaces for two 20' x 30' vendor or sponsor tent	1,200	paved space with power pedestals at concourse or field level
Subtotal - Exterior Spaces			2,700	NASF

Recommended Facilities Space Program

Recreation Gym and Natatorium

RECREATION GYM AND NATATORIUM - PROGRAM SPACE			NASF	REMARKS
A. Public Services				
A.	1.	Vestibule/Lobby	1500	
A.	2.	Entry Control and Event Ticket Sales	180	
A.	3.	Food and Beverage	200	2 points-of-sale
A.	4.	Vending Machine Alcove	100	adjacent to Lobby/Lounge
A.	5.	Women's Public Restroom	245	5 waterclosets, 2 lavatories
A.	6.	Men's Public Restroom	215	1 watercloset, 2 urinals, 2 lavatories
Subtotal - Public Services			2,440	NASF
B. Field House				
B.	1.	Field House	18,600	3 high school length multi-purpose Courts, Long/Triple Jump pit, Pole Vault runway, Batting Cages (2)
B.	2.	Track Equipment Storage	500	
B.	3.	Varsity Team Equipment Storage	200	other outdoor sports
B.	4.	Intramural Sports and Club Storage	300	
Subtotal - Field House			19,600	NASF

RECREATION GYM AND NATATORIUM - PROGRAM SPACE			NASF	REMARKS
C. Natatorium and Support Functions				
C.	1.	Pool and Pool Deck	10,300	Assumes 25Y x 8-lane pool with no Diving
C.	2.	Spectator Grandstand and Walkway	2,500	400 net seating capacity
C.	3.	Wet Classroom/Meet Management Room	500	Capacity 25, dry side and pool deck access
C.	4.	Lifeguard Work Room	200	three workstations and break area
C.	5.	First Aid	100	
C.	6.	Recreation and Club Equipment Storage	800	
C.	7.	Pool Filtration and Heater Room	700	
C.	8.	Pool Sanitizer Room	50	
C.	9.	Pool pH Buffer Room	50	
C.	10.	Laundry	150	for washing lost and found towels, etc.
Subtotal - Natatorium and Support Functions			15,350	NASF
D. Aquatics Office Suite				
D.	1.	Pool Control Station	200	
D.	2.	Director of Aquatics	120	Future position?
D.	3.	Swimming Head Coach Office	120	Future position?
D.	4.	Assistant Coaches' Work Room	120	2 workstations
Subtotal - Aquatics Office Suite			560	NASF

Recommended Facilities Space Program

Recreation Gym and Natatorium

RECREATION GYM AND NATATORIUM - PROGRAM SPACE			NASF	REMARKS
E. Locker Rooms (Based on Assumed Maximum Bather Load of 246)				
E.	1.	Women's Visiting Team/General Dressing Room	480	54 Z-type lockers @ 15" x 18"
E.	2.	Women's Swimming Team Dressing Room	500	30 varsity style lockers @ 18" x 18"
E.	3.	Women's Shower/Toilet Room	800	8 shower stalls, 4 waterclosets, 4 lavatories
E.	4.	Men's Visiting Team/General Dressing Room	480	
E.	5.	Men's Swimming Team Dressing Room	500	
E.	6.	Men's Shower/Toilet Room	800	8 shower stalls, 2 waterclosets, 2 urinal, 4 lavatories
E.	7.	Gender Neutral Dressing/Shower/Toilet Room	90	
E.	8.	Gender Neutral Dressing/Shower/Toilet Room	90	
Subtotal - Locker Rooms			3,740	NASF

RECREATION GYM AND NATATORIUM - PROGRAM SPACE			NASF	REMARKS
F. Building Operations				
F.	1.	General Storage	500	
F.	2.	Loading/Receiving Area	150	
F.	3.	Domestic Hot Water	500	
F.	4.	HVAC Fan Rooms and Domestic Hot Water	2,200	
F.	5.	Main Electrical Switch Room	100	
F.	6.	Electrical Panel Room	50	
F.	7.	Telecommunications Hub Room	80	
F.	8.	Master Custodial Closet	90	
F.	9.	Custodial Closet	50	
F.	10.	Custodial Closet	50	
Subtotal - Building Operations			3,770	NASF
Subtotal Net Area Requirement			45,460	NASF
Circulation, mechanical, chases, wall thickness			15,152	75% Efficiency
Grand Total Gross Area Requirements			60,612	GSF

SportsPLAN Studio in association with BOUDREAUX

Recommended Facilities Space Program

New Baseball Stadium

1,500 SEAT BASEBALL STADIUM IMPROVEMENTS - PROGRAM SPACE			NASF	REMARKS
A. Spectator Services				
A.	1.	Stadium Box Office	200	3 points-of-sale
A.	2.	Food and Beverage Stand(s)	840	6 points-of-sale
A.	3.	Food and Beverage Dry Storage	160	
A.	4.	First Aid Room/Spectator Services	180	
A.	5.	Women's Restroom(s)	1,200	approximately 19 water closets, 5 lavatories - confirm code requirements
A.	6.	Men's Restroom(s)	600	approximately 4 water closets, 6 urinals, 4 lavatories - confirm code requirements
A.	7.	Family Restroom A	80	1 water closet, 1 lavatory
A.	8.	Family Restroom B	80	1 water closet, 1 lavatory
A.	9.	Merchandise Sales	240	3 points-of-sale
A.	10.	Merchandise Storage	50	
Subtotal - Spectator Services			3,630	NASF

1,500 SEAT BASEBALL STADIUM IMPROVEMENTS - PROGRAM SPACE			NASF	REMARKS
B. Press Box				
B.	1.	Elevator Lobby/Hospitality Area	300	Capacity 20 people
B.	2.	Working Press, Statisticians and OPS Staff	300	10 working positions @ 30" min.
B.	3.	Broadcast Booth A	110	3 people
B.	4.	Broadcast Booth B	110	3 people
B.	5.	Broadcast Booth C	110	tricastor space
B.	6.	Public Address Booth	110	3 people
B.	7.	Official Scorer	110	3 people
B.	8.	Video Board Control and Production	140	3 people
B.	9.	High Home Camera Booth	60	
B.	10.	Voice/Data Equipment Room	40	
B.	11.	Sound and Video Equipment Room	100	component racks
B.	12.	Food and Beverage Service	160	Microwaves, sinks, refrigerators, warming carts, ice machine, warming oven, counter
B.	13.	Printer/Copier/Staff Work Room	100	
B.	14.	Women's Restroom	170	3 water closets, 2 lavatories-confirm code requirements
B.	15.	Men's Restroom	160	1 water closet, 2 urinals, 2 lavatories-confirm code requirements
B.	16.	Domestic Hot Water	40	
B.	17.	Air Handler	240	Appropriately distributed
B.	18.	Electrical Panel Room	60	
B.	19.	Custodian and Supply Storage	100	mop sink
B.	20.	Rooftop Videographer Position	200	
Subtotal - Stadium Press Box			2,720	NASF

SportsPLAN Studio in association with BOUDREAUX

Recommended Facilities Space Program

New Baseball Stadium

1,500 SEAT BASEBALL STADIUM IMPROVEMENTS - PROGRAM SPACE				NASF	REMARKS
C. Trojans Baseball Clubhouse					
C.	1.	AU Baseball Dressing Room	0	45 lockers @ 18" W x 18" D x 84" H	
C.	2.	Showers/Toilets	0	8 shower heads, 3 water closets, 2 urinals, 5 lavatories - confirm code requirements	
C.	3.	Head Coach's Office	0		
C.	4.	Assistant Coach's Office	0		
C.	5.	Assistant Coach's Office	0		
C.	6.	Coaches' Meeting Room	0		
C.	7.	Coaches' Dressing Room	0	5 custom lockers @ 18" W x 18" D x 84" H	
C.	8.	Coaches' Shower/Toilet Room	0	2 shower stalls, 1 water closet, 1 urinal, 2 lavatories	
C.	9.	Video Study Space	0	meeting space for up to 8	
C.	10.	Indoor Hitting Facility	5,600	4 sliding cages shared with Softball	
C.	11.	Catchers' Equipment Storage Room	50	Supplemental exhaust fans, ozonator	
C.	12.	Equipment and Uniform Storage Room	0		
C.	13.	Laundry Room	0	2-50# washers, 2-75# dryers, soak sink	
C.	14.	Custodian Closet	50	Proximate to Locker Rooms	
C.	15.	Domestic Hot Water	0	Proximate to Laundry Room and Showers	
C.	16.	Air Handler	70		
C.	17.	Electrical Panel Room	50	Proximate to Laundry Room and Showers	
C.	18.	Voice/Data Equipment Room	40		
Subtotal - Trojans Baseball Clubhouse			5,860	NASF	

SportsPLAN Studio in association with BOUDREAUX

1,500 SEAT BASEBALL STADIUM IMPROVEMENTS - PROGRAM SPACE				NASF	REMARKS
D. Umpires' Facilities					
D.	1.	Umpires' Dressing Room	300	2 sets of three lockers with integral bench	
D.	2.	Umpires' Shower/Toilet Room A	150	1 shower stall, 1 water closet, 1 lavatory	
D.	3.	Umpires' Shower/Toilet Room B	150	1 shower stall, 1 water closet, 1 lavatory	
D.	4.	Field Level Video Replay Booth	120	3 people	
Subtotal - Umpires' Facilities			720	NASF	
E. Stadium Operations					
E.	1.	Dugout Toilet Rooms	100	Two at 50 SF each	
E.	2.	Electrical Panel Room	50	for Spectator Services building(s)	
E.	3.	Field Lighting Control Room	100		
E.	4.	Concourse Custodian and Supply Storage	100	mop sink	
E.	5.	Grounds Maintenance Garage and Shop	800	confirm with Owner's equipment list	
E.	6.	Mound Clay and Conditioner Store Room	200		
Subtotal - Stadium Operations			1,350	NASF	
Total Net Conditioned Space			14,280	NASF	
Horizontal circulation, mechanical, chases, partition			6,120	70% Efficiency	
Grand Total Gross Conditioned Space			20,400	GSF	
F. Exterior Spaces					
F.	1.	Picnic Plaza	1,500	Space for 50 at picnic tables, lawn chairs or 4Topps™	
F.	2.	Spaces for two 20' x 30' vendor or sponsor tent	1,200	paved space with power pedestals at concourse or field level	
F.	3.	Covered and screened Field Equipment Storage	600		
Subtotal - Exterior Spaces			3,300	NASF	

Recommended Facilities Space Program

Indoor Tennis Courts

INDOOR TENNIS COURTS - PROGRAM SPACE			NASF	REMARKS
A. Tennis Facilities				
A.	1.	Gender Neutral Restrooms	210	3 at 70 NASF each
A.	2.	Indoor Courts	26,520	
A.	3.	Spectator Seating	2,000	
A.	4.	Court Equipment Storage	180	
Subtotal - Spectator Services			28,910	NASF
B. Building Operations				
B.	1.	Court Lighting and Sound Equipment Room	120	
B.	2.	Electrical Panel Room	50	
B.	3.	Custodial Closet	50	
Subtotal - Building Operations			220	NASF
Subtotal Net Area Requirements			29,130	NASF
Circulation, mechanical, chases, wall thickness			5,141	85% Efficiency
Grand Total Gross Area Requirements			34,271	GSF

Varsity Golf Center

VARSITY GOLF CENTER - PROGRAM SPACE			NASF	REMARKS
A. Golf Team Spaces				
A.	1.	Golf Team Lounge and Meeting Space	400	
A.	2.	Team Equipment Storage	200	
A.	3.	Swing Analysis Lab and Club Tuning Shop	500	
A.	4.	Gender Neutral Restrooms	210	3 at 70 NASF each
Subtotal - Spectator Services			1,310	NASF
B. Building Operations				
B.	1.	General Storage	0	
B.	2.	HVAC Fan Room	100	
B.	3.	Main Electrical Switch Room	50	
B.	4.	Electrical Panel Room	50	
B.	5.	Custodial Closet	50	
Subtotal - Building Operations			250	NASF
Subtotal Net Area Requirements			1,560	NASF
Circulation, mechanical, chases, wall thickness			515	75% Efficiency
Grand Total Gross Area Requirements			2,075	GSF

Recommended Facilities Space Program

2,500 Seat Arena

FUTURE 2,500 SEAT ARENA - PROGRAM SPACE			NASF	REMARKS
A. Spectator Areas				
General Seating				
A.	1.	2,500 Seats and Aisles	12,400	700 additional floor seats for concerts and commencements
Premium Spectator Facilities				
A.	2.	Club Lounge	1,000	
A.	3.	Warming Kitchen	340	
Subtotal - Spectator Areas			13,740	NASF
B. Event Guest Services				
B.	1.	Entrance/Lobby	3,600	
B.	2.	Box Office	200	4 points-of-sale x 50 SF
B.	3.	Box Office Manager and Vault	160	
B.	4.	Spectator Concourses	18,000	
B.	5.	Concessions Stands	720	3,200 maximum capacity: 12 points-of-sale x 60 SF
B.	6.	Merchandise Stands	300	3,200 maximum capacity: 6 points-of-sale x 50 SF
B.	7.	Concourse Restrooms-Women	2,400	40 waterclosets, 21 lavatories
B.	8.	Concourse Restrooms-Men	1,320	8 waterclosets, 14 urinals, 12 lavatories
B.	9.	Spectator Services/First Aid	200	
Subtotal - Event Guest Services			26,900	NASF

FUTURE 2,500 SEAT ARENA - PROGRAM SPACE			NASF	REMARKS
C. Facility Management Office Suite				
C.	1.	Reception/Waiting Room	160	
C.	2.	Conference Room	320	Capacity 16
C.	3.	Administrative Assistant	100	
C.	4.	Facility Director	140	
C.	5.	Events Manager	120	
C.	6.	Concessions Manager	120	
C.	7.	Staff Work Room	200	
C.	8.	Staff Break Room	160	residential kitchen appliances
Subtotal - Facility Management Office Suite			1,320	NASF
D. Coaches' Offices				
Women's Basketball Suite				
D.	1.	Women's Basketball Head Coach	140	
D.	2.	Women's Basketball Assistant Coach	110	
D.	3.	Women's Basketball Assistant Coach	110	
Men's Basketball Suite				
D.	4.	Men's Basketball Head Coach	140	
D.	5.	Men's Basketball Assistant Coach	110	
D.	6.	Men's Basketball Assistant Coach	110	
Common Spaces				
D.	7.	Basketball Conference Room	240	Capacity 12
D.	8.	Video Editing and Grad Assistant Work Space	200	
D.	9.	Staff Kitchenette	120	
D.	10.	Copy/Work Room	120	
D.	11.	File Storage	120	
D.	12.	Office Supply Storage	60	
Subtotal - Coaches' Office			1,580	NASF

SportsPLAN Studio in association with BOUDREAUX

Recommended Facilities Space Program

2,500 Seat Arena

FUTURE 2,500 SEAT ARENA - PROGRAM SPACE			NASF	REMARKS
E. Anderson University Locker Rooms				
E.	1.	AU Women's Basketball Dressing Room	700	18 lockers @ 24" x 24" x 84"
E.	2.	AU Women's Basketball Team Lounge	700	
E.	3.	Women's Basketball Shower/Toilet Room	600	6 shower stalls, 3 waterclosets, 5 lavatories
E.	4.	AU Men's Basketball Dressing Room	700	18 lockers @ 24" x 24" x 84"
E.	5.	AU Men's Basketball Team Lounge	700	
E.	6.	Men's Basketball Shower/Toilet Room	600	6 shower stalls, 2 waterclosets, 2 urinals, 4 lavatories
E.	7.	Female Coaches/Staff Dressing Room	360	8 lockers @ 24" x 24" x 84"
E.	8.	Female Coaches/Staff Shower/Restroom	250	2 showers, 2 waterclosets, 2 lavatories
E.	9.	Male Coaches/Staff Dressing Room	360	8 lockers @ 24" x 24" x 84"
E.	10.	Male Coaches/Staff Shower/Restroom	250	2 showers, 1 waterclosets, 1 urinal, 2 lavatories
Subtotal - Anderson University Locker Rooms			5,220	NASF
F. Meeting Rooms				
F.	1.	Men's Team Meeting Room	640	Capacity 24
F.	2.	Women's Team Meeting Room	640	Capacity 24
F.	3.	Meeting Room Storage	100	Shared by meeting rooms
Subtotal - Event Guest Services			1,380	NASF

FUTURE 2,500 SEAT ARENA - PROGRAM SPACE			NASF	REMARKS
G. Other Dressing Rooms				
G.	1.	Visiting Team Changing Room A (capacity 20)	300	Continuous bench, shelf and rod
G.	2.	Visiting Team Shower/Restroom	340	4 shower heads, 2 waterclosets, 1 urinals, 3 lavatories
G.	3.	Visiting Team Changing Room B (capacity 20)	300	Continuous bench, shelf and rod
G.	4.	Visiting Team Shower/Restroom	340	4 shower heads, 2 waterclosets, 1 urinals, 3 lavatories
G.	5.	Officials' Changing Room - Women	180	6 lockers @ 15 x 18" x 60"
G.	6.	Officials' Shower/Restroom	260	
G.	7.	Officials' Changing Room - Men	180	6 lockers @ 15 x 18" x 60"
G.	8.	Officials' Shower/Restroom	260	2 showers, 2 waterclosets, 2 lavatories
G.	9.	Officials' Common Room	180	
Subtotal - Other Dressing Rooms			2,340	NASF

Recommended Facilities Space Program

2,500 Seat Arena

FUTURE 2,500 SEAT ARENA - PROGRAM SPACE			NASF	REMARKS
H. Operations				
H.	1.	Event Floor	9,600	
H.	2.	Sound/Lighting Control Room	180	
H.	3.	Broadcast and Video Production Center	220	
H.	4.	Event Storage	1,000	Adjacent to Arena Floor
H.	5.	Electrical Panel Rooms	120	
H.	6.	Switchgear	160	
H.	7.	Main Telephone/Data Equipment Room	100	
H.	8.	Telephone/Data Equipment Rooms	150	Assume three rooms at 50 SF each
H.	9.	Boilers, Chillers, Heat Exchangers and Pumps	1,600	
H.	10.	Air Handlers	2,000	
H.	11.	Elevators and Stairs	1,080	
H.	12.	Custodian	360	Assume six rooms at 60 SF each
H.	13.	Custodial Supply Storage	200	
H.	14.	Merchandise Central Storage	300	
H.	15.	Truck Dock and Event Staging Area	5,760	four bays @ 72' x 20'
Subtotal - Operations			22,830	NASF
Subtotal Net Area Requirements			75,310	NASF
Circulation, mechanical, chases, wall thickness			13,290	85% efficient
Grand Total Gross Area Requirements			88,600	GSF

Additional Plan Option

The team explored an additional option for including academic and/or residential facilities on the athletics campus. This could be a long-term view of maximizing the property and integrating athletics and recreation within the broader university context.

